

# Water Spring MS Community Meeting

- Welcome! To give everyone the opportunity to have their questions addressed:
  - All participant audio lines will be **muted**.
  - Use **Q&A** to enter your question.
    - Click on the “...” on your toolbar | select Q&A
  - The meeting host will read question(s) aloud for response by the panel.
  - If your question needs to be clarified, the host may unmute your line.

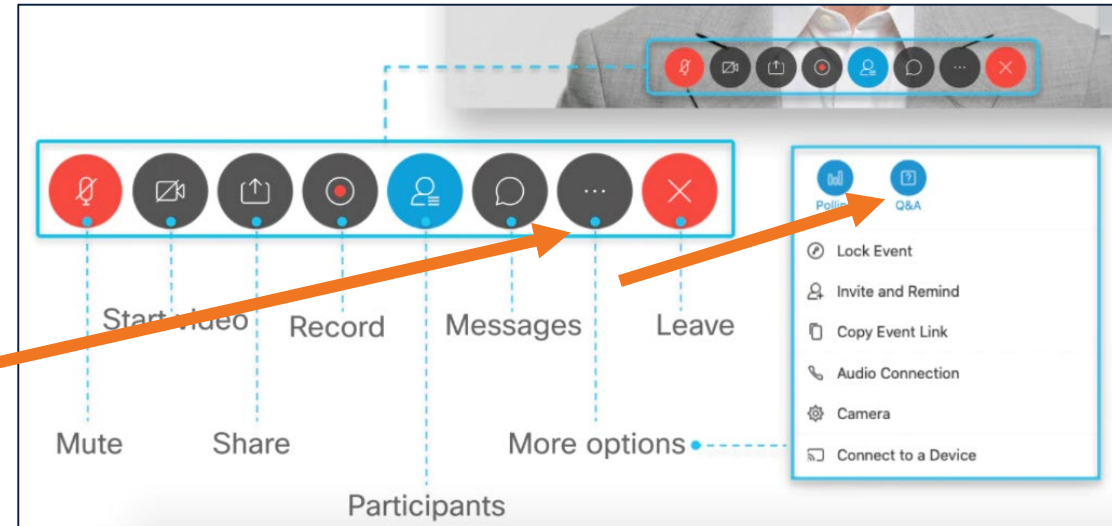

March 2, 2021

# 30% Design Community Meeting

## Water Spring MS – Site 65-M-W-4



**Orange County  
Public Schools**

# Water Spring Middle School 30% Design Meeting Agenda

March 2, 2021

- Welcome – Pam Gould, School Board Vice-Chair, District 4
- Introductions – Lauren Roth, Facilities Communications
- School Update – Laura Beusse, Principal
- Project Update – Architect: Harvard Jolly Architecture

Construction Manager: CORE Construction

- Questions & Answers
- Adjournment

***Welcome Message from  
District 4 Board Member  
Pam Gould***





***Introductions by Senior manager,  
Facilities Communications***

**Lauren Roth**



***Principal of Horizon High School &  
Water Spring Middle School***

**Laura Beusse**

- Two years at temporary location
- Introducing the dedicated AP for WSMS



***Dedicated Assistant Principal  
for Water Spring MS***

**Brian Sanchez Corona**





# Vicinity Map





# Aerial of Existing Site





# Site Plan

## PROJECT DATA

### Capacity

1215 Students

### Parking

Provided: 183 spaces

Required: 174 spaces

### Car Queuing

Provided: 206 Cars (13.9%)

Required (Traffic Study): 119 Cars (8%)

### Buses

Provided: 28 buses

Required: 28 buses

### Future Portables

12 Portables

### Site Area

+/- 25 Acres

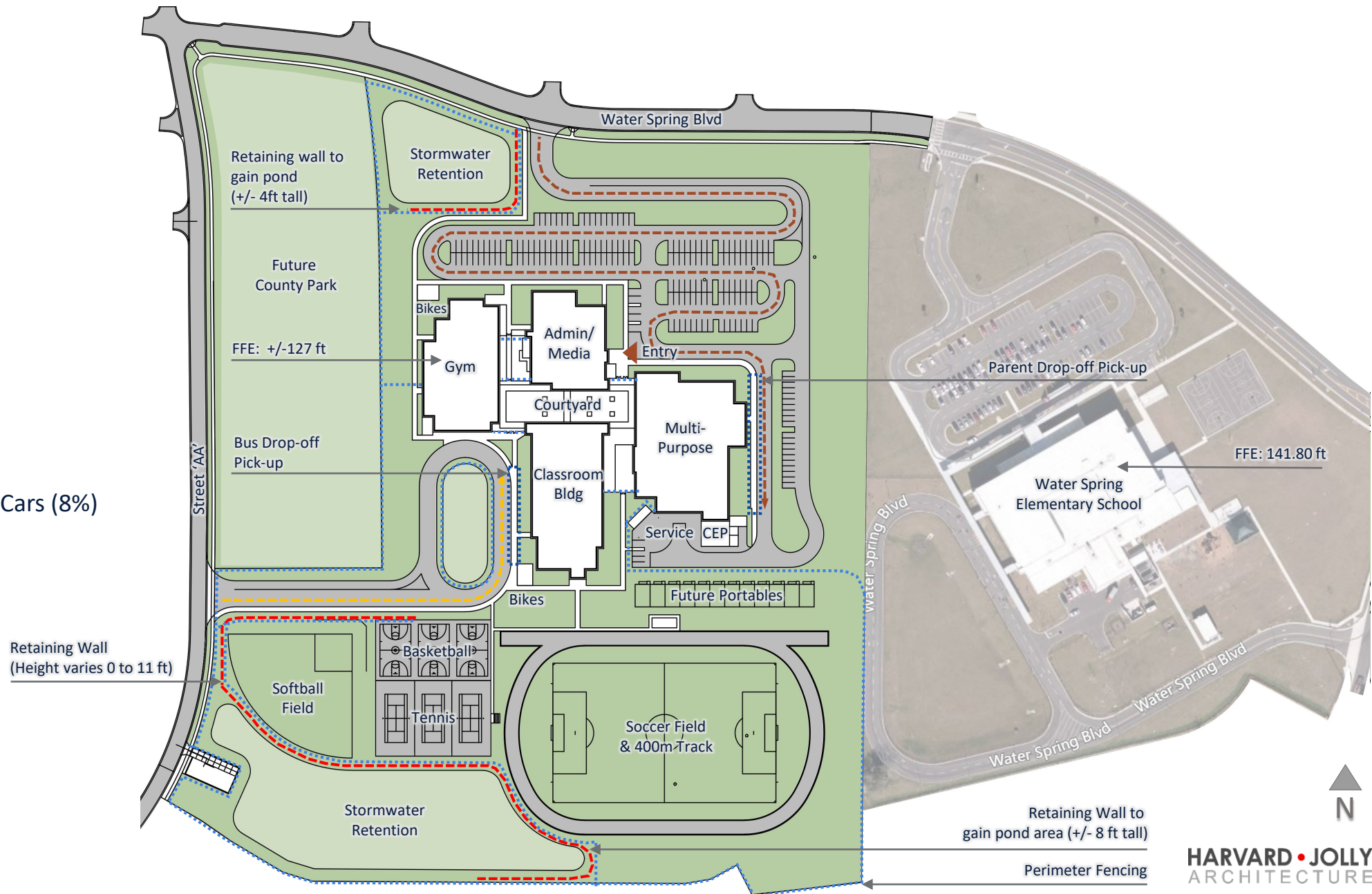

# First Floor Plan

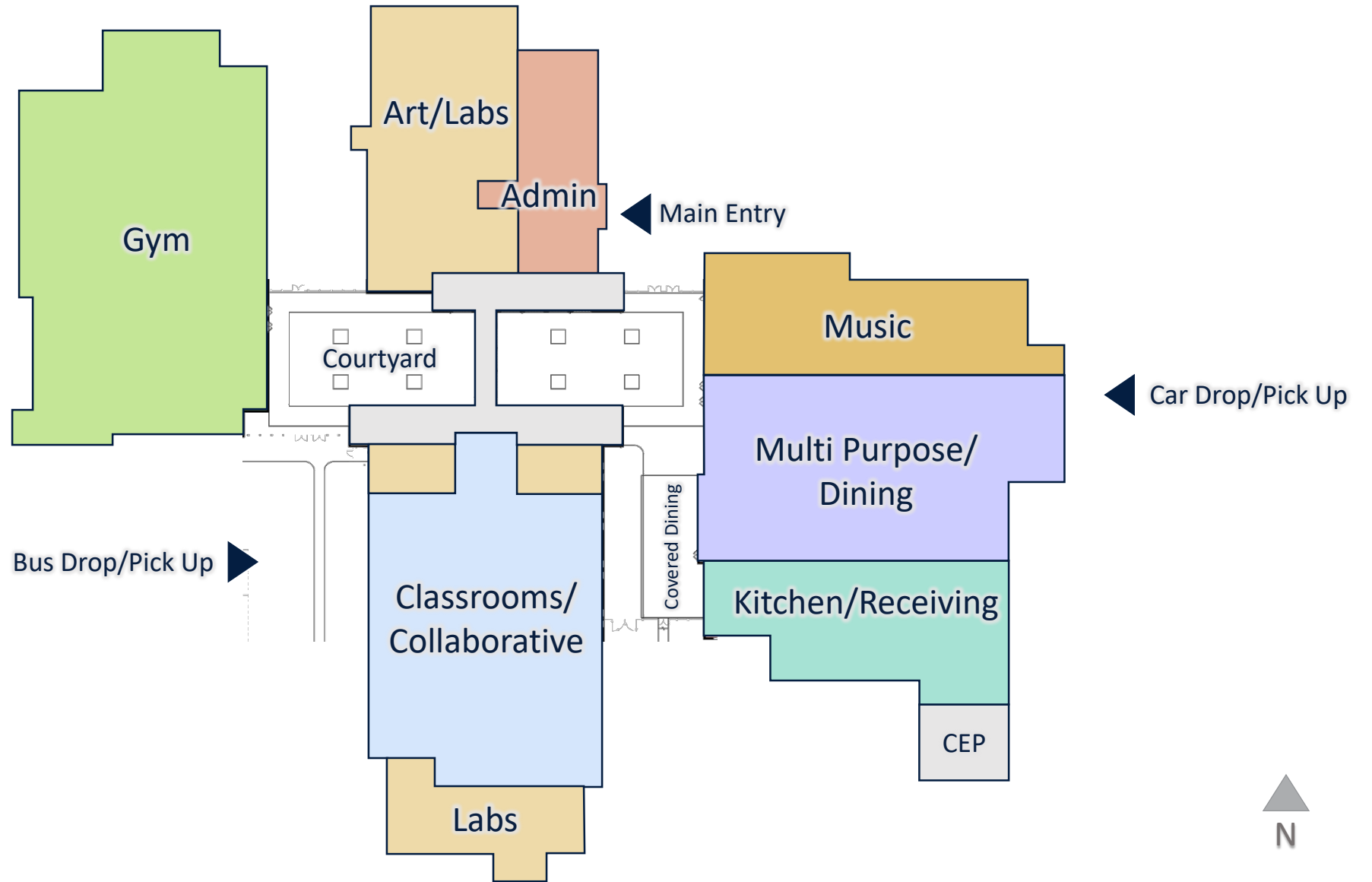

# Second Floor Plan

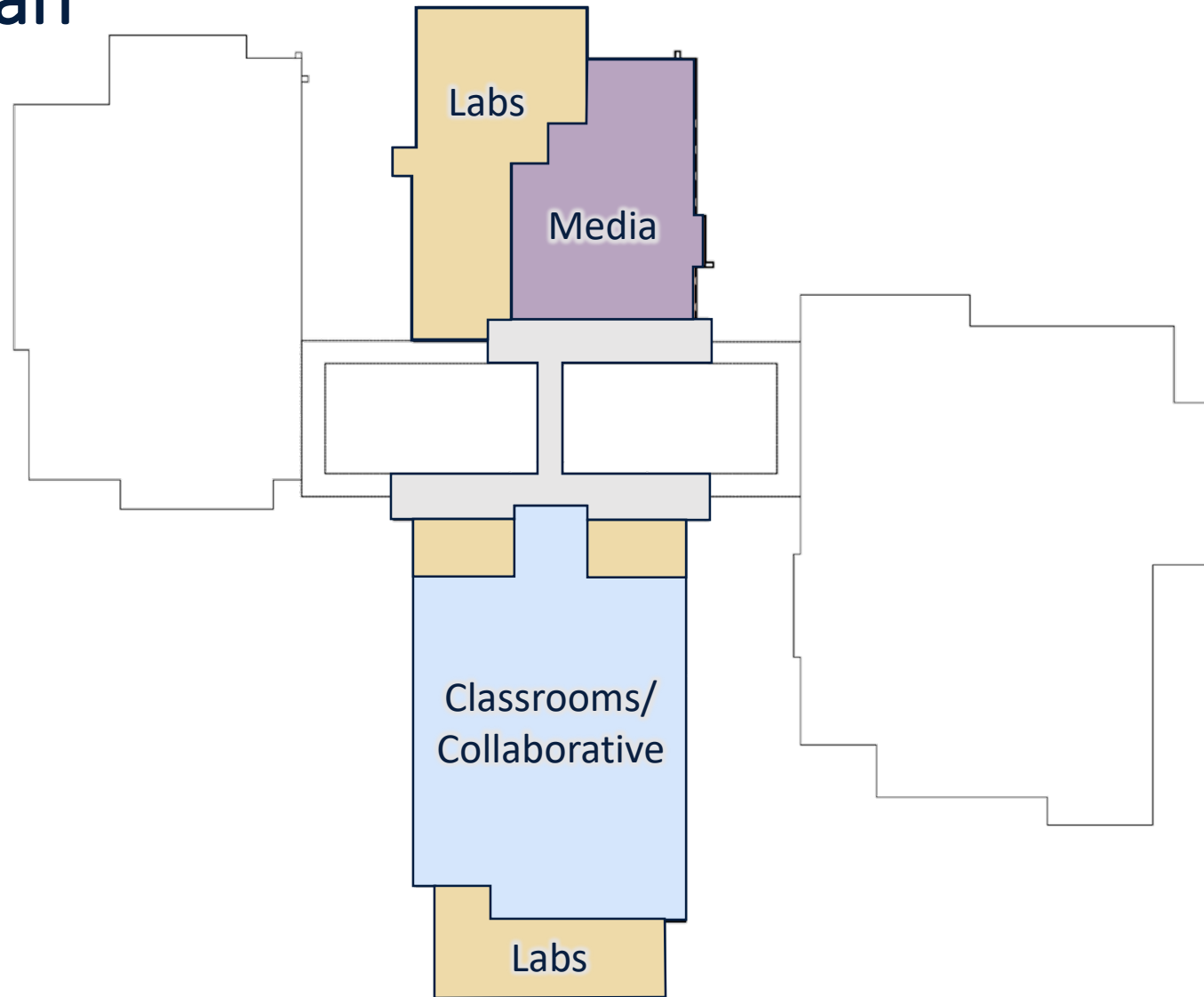



# Third Floor Plan

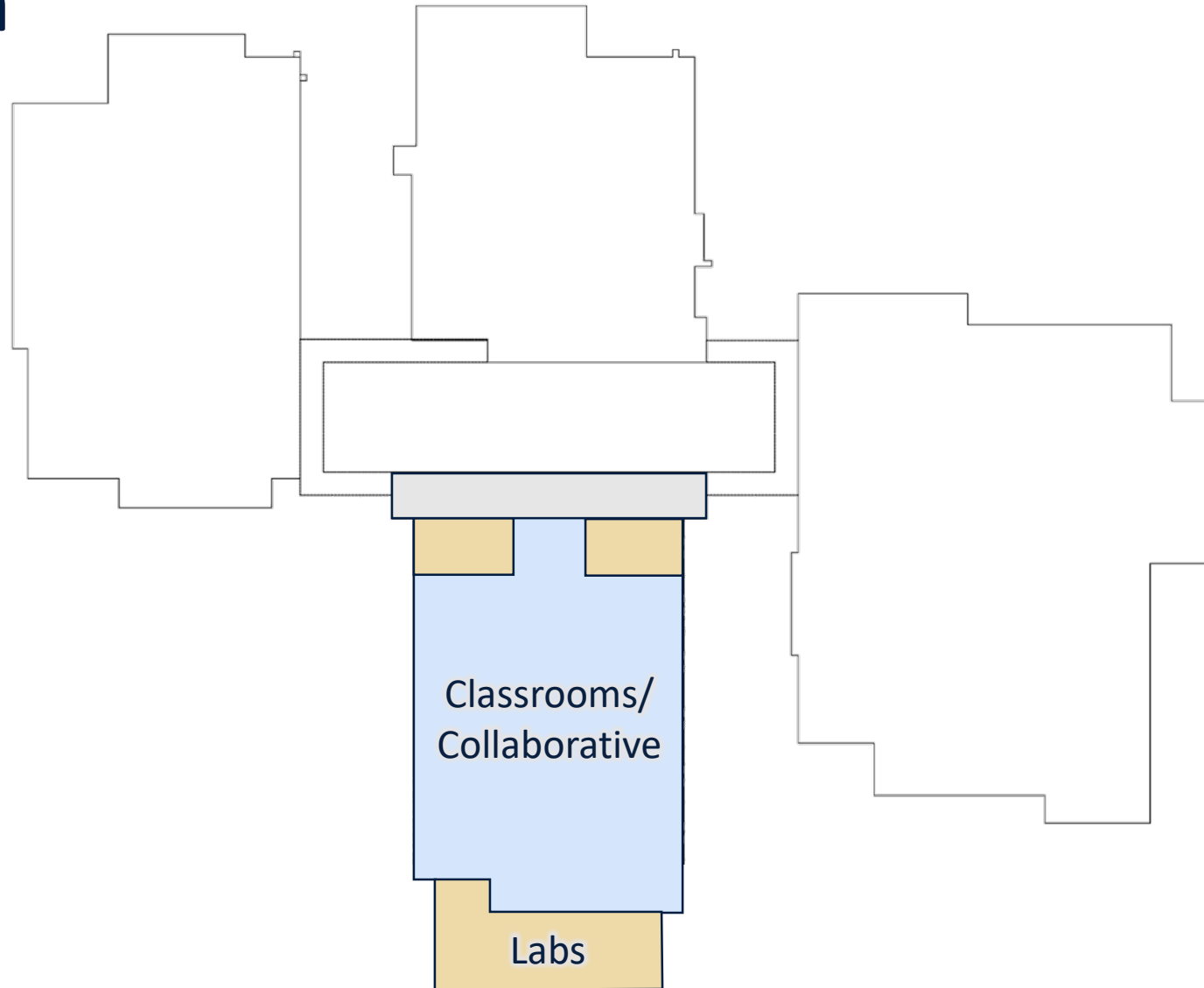

# Sustainable Features include:

## Site

- Native/low water landscaping – reduced water consumption
- Low Impact Design (LID) stormwater design

## Building

- 10% more energy efficient than ASHRAE 90.1 standard
- High Efficiency Chillers (8% energy reduction)
- Light colored roof reduces heat gain and improves energy efficiency
- Energy Star rated equipment
- Water saving toilets, faucets and fixtures
- All general classrooms have daylighting
- Over 75% of ALL spaces have daylighting
- Fully automated building control system

# Harvard Jolly Middle School Prototype

School	Year Open
Horizon West Middle School	2019
Innovation Middle School	2017



# Example – Entry





# Example – Lobby





# Example – Typical Classroom





# Example – Technology Resource Center





# Example – Typical Classroom Corridor





# Example – Typical Science Lab





# Example – Media Center





# Example – TV Studio





# Example – Art Lab





# Example – Multi Purpose Room





# Example – Kitchen





# Example – Gymnasium





# Example – Courtyard





# Example – Hardcourt





# Example – Soccer Field and Track





# Project Schedule

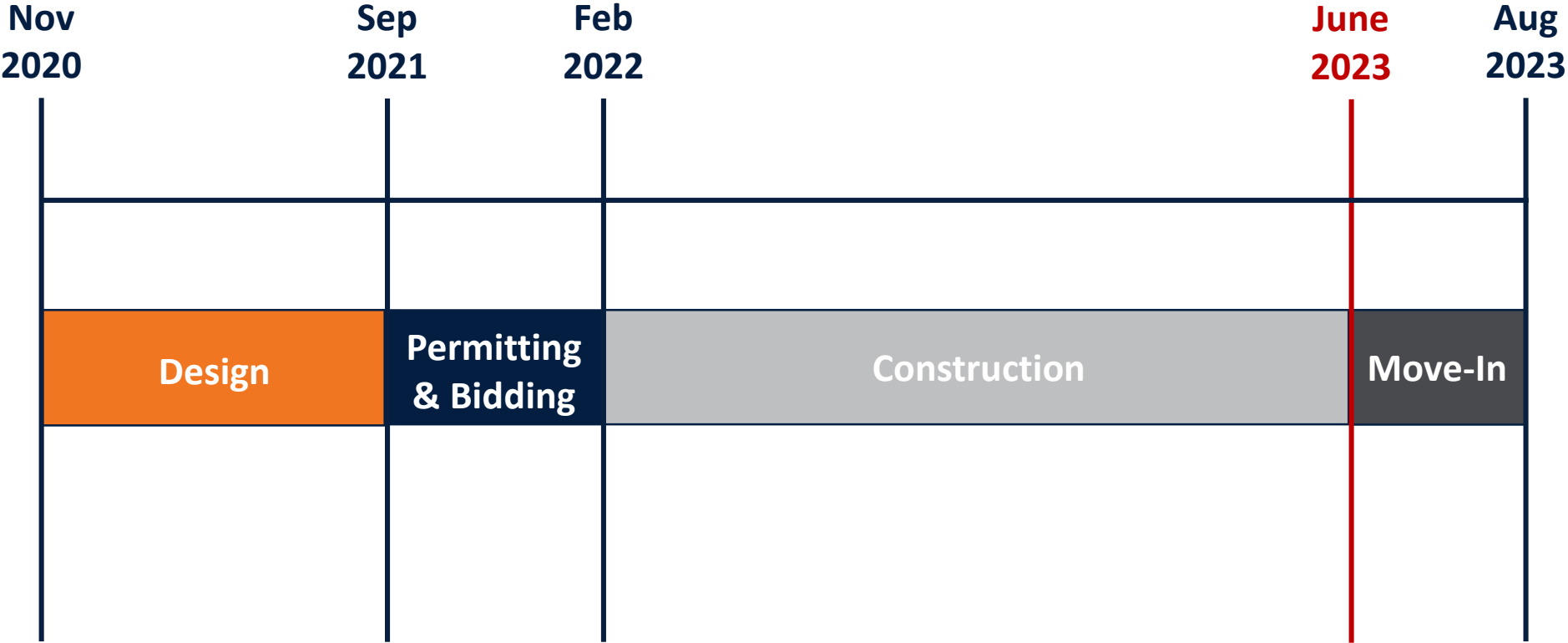

# What to Expect

DEVELOPER MILESTONES	ANTICIPATED DATES
Site Limits and Finish Floor Elevation	Complete
Road/Infrastructure Design Completed	Complete
FDEP Permits Issued	Complete
Temp Access Road	Complete
Burning and Clearing on Waterleigh site	Complete
Storm Ready for Tie-in	5/28
Site Pad Ready	6/1
Temp Utilities	7/2
Offsite Utilities Complete	7/2
Final Road/Utilities	8/21





# Questions & Answers

# Water Spring MS Community Meeting

- Welcome! To give everyone the opportunity to have their questions addressed:
  - All participant audio lines will be **muted**.
  - Use **Q&A** to enter your question.
    - Click on the “...” on your toolbar | select Q&A
  - The meeting host will read question(s) aloud for response by the panel.
  - If your question needs to be clarified, the host may unmute your line.

